



**salton®**  
**VitaPro**  
stainless steel  
citrus juicer



**Instruction Booklet**

Model CJ1484

# IMPORTANT SAFEGUARDS

When using electrical appliances, basic safety precautions should always be followed including the following:

1. Read all instructions.
2. To protect against electrical hazards, do not immerse cord, plugs, or the appliance in water or other liquid.
3. Close supervision is necessary when any appliance is used by or near children.
4. Unplug from outlet when not in use and before cleaning.
5. **DO NOT** operate any appliance with a damaged cord or plug or after the appliance malfunctions, or has been damaged in any manner. Return appliance to Salton for examination, repair or adjustment. See "Warranty" section.
6. The use of accessories or attachments not recommended by Salton may cause hazards.
7. **DO NOT** use outdoors.
8. **DO NOT** let cord hang over edge of table or counter, or touch hot surfaces.
9. **DO NOT** place on or near a hot gas or electric burner, or in a heated oven.
10. This appliance is for Household Use Only. **DO NOT** use appliance for other than its intended use.
11. **DO NOT** leave unit unattended while in use.

# SAVE THESE INSTRUCTIONS

## HOUSEHOLD USE ONLY

### POLARIZED PLUG

This appliance has a polarized plug (one blade is wider than the other). To reduce the risk of electric shock, this plug will fit in a polarized outlet only one way. If the plug does not fit fully in the outlet, reverse the plug. If it still does not fit, contact a qualified electrician. Do not modify the plug in any way.

## DESCRIPTION OF PARTS

1. Cover
2. Large Reamer
3. Small Reamer
4. Strainer
5. Juice Container
6. Sealable Spout
7. Drive Shaft
8. Base
9. Suction Feet

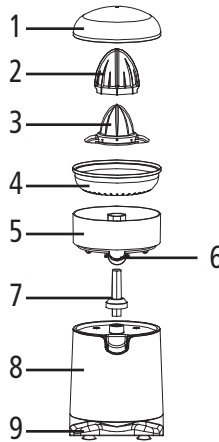

## BEFORE FIRST USE

To disassemble see the Care and Cleaning Section. Wash the Cover, Large and Small Reamers, Strainer and Juice Container in warm soapy water. Wipe the Base with a damp cloth. **NEVER IMMERSE THE BASE IN WATER OR ANY OTHER LIQUID.**

## HOW TO USE

1. Place the juicer on a clean flat, level surface that is easy to clean.
2. The juicer is equipped with Suction Feet which will adhere to any flat and smooth surface which is free of dust or grease. Slightly moisten the suction feet before you press them onto the surface. **NOTE:** Suction Feet will not adhere to textured surfaces.
3. Depending on the size of fruit you are juicing, you can use either the Large or Small Reamer.
4. If you are juicing small citrus fruit such as lemons or limes, fit the Small Reamer directly into the drive shaft.
5. If you are juicing larger citrus fruit such as grapefruits or oranges, fit the Small Reamer onto the drive shaft first, then fit the Large Reamer over the top of the Small Reamer. **NOTE:** To separate the Reamers, hold the Large Reamer above the tabs of the Small Reamer, gently squeeze and pull off.

6. Plug Citrus Juicer into a 120 V outlet.
7. Roll fruit between the palm of your hand and the counter top to break down fibers. Cut fruit in half crosswise. **NOTE:** Fruit at room temperature will yield more juice.
8. Press the cut side of the fruit down on the Reamer. The Reamer will begin to turn. Move the fruit from side to side to get the maximum amount of juice. **IMPORTANT:** If you apply too much pressure to the Reamer, the motor may seize.
9. If you wish to collect the juice in the container, press the spout upwards to close it.
10. If you wish to run the juice directly into a glass, press the spout downwards.
11. If pulp begins to build up in the Strainer, remove the Reamer(s) and Strainer and remove pulp. Replace the Strainer and Reamer(s) and continue juicing. **NOTE: DO NOT** operate for longer than 6 minutes without interruption.
12. When finished juicing, unplug unit from outlet.

## **CARE AND CLEANING**

1. Unplug from outlet.
2. The Cover, Reamers, Strainer, Juice Container and Drive Shaft can be washed in warm soapy water or in the top rack of the dishwasher. Wipe Base with a damp cloth. **DO NOT IMMERSE THE BASE IN WATER OR ANY OTHER LIQUID.**
3. If you use the spout on the Juice Container frequently, pulp may build up in the spout. Therefore clean the spout after each use.
4. To reassemble, place Drive Shaft in first, then place the Juicing Container on top. Position the Strainer over the Juicing Container. Fit Large Reamer over Small Reamer and slide on Drive Shaft. Place the cover on top of unit.

A short supply cord is provided to reduce the hazards of becoming entangled in or tripping over a long cord. Extension cords may be used if care is exercised in their use. If an extension cord is used, the marked electrical rating of the detachable power-supply cord or extension cord should be at least as great as the electrical rating of the appliance. If the appliance is of the grounded type, the extension cord should be a grounded 3-wire cord. The extension cord should be arranged so that it will not drape over the counter top or table top, where it can be pulled on by children or tripped over.

#### **LIMITED WARRANTY**

**\*\*The original sales receipt is the only acceptable proof of purchase\*\***

Salton Canada warrants that this appliance shall be free from defects in material and workmanship for a period of two (2) years from the date of original purchase. Salton Canada, at its sole discretion during this warranty period, will repair or replace a defective product or issue a refund. Any refund to the purchaser will be at a pro-rated value based on the remaining period of the warranty. All liability is limited to the amount of the purchase price. This warranty covers normal domestic usage and does not cover damage which occurs in shipment or failure which results from alteration, accident, misuse, abuse, glass breakage, neglect, improper maintenance, use contrary to the operating instructions or commercial use. This warranty is not available to retailers or other commercial purchasers or owners.

This warranty does not include the cost of shipping, which is to be borne by the customer.

## TO OBTAIN PROMPT WARRANTY SERVICE:

Contact one of our many Service Centers found on our website  
[www.salton.com/customer-care](http://www.salton.com/customer-care)

or

Securely package and return the appliance to us. Please enclose:

- Original proof of purchase
- The completed form below with a \$12.50 Return Shipping & Handling fee – either a cheque, money order or credit card (A personal cheque will delay return shipping by 2-3 weeks)

For added protection, we suggest that you use an insured delivery service with tracking information when returning your product. Salton Canada will not be held responsible for in-transit damage or for packages that are not received.

This warranty does not include the cost of shipping, which is to be borne by the customer.

.....

Name \_\_\_\_\_

Address \_\_\_\_\_

City \_\_\_\_\_ Prov/State \_\_\_\_\_ Postal/Zip Code \_\_\_\_\_

Daytime Phone No. \_\_\_\_\_ Email \_\_\_\_\_

Product defect: \_\_\_\_\_

Type of payment      Cheque/Money Order       Visa       MasterCard

Name on card \_\_\_\_\_ Expiry Date \_\_\_\_\_ CSV No \_\_\_\_\_

Card No. \_\_\_\_\_

To contact our Customer Service Department:

**SALTON CANADA**  
81A Brunswick,  
Dollard-des-Ormeaux, Quebec H9B 2J5  
Canada

Telephone: 514-685-3660 (Ext. 226)  
E-mail: [service@salton.com](mailto:service@salton.com)  
Fax: 514-685-8300  
[www.salton.com](http://www.salton.com)